

**Eldridge Park  
City of Sugar Land**

February 06, 2018

Fenglin Du, PLA, ASLA  
City of Sugar Land  
10405 Corporate Drive Suite 250  
Sugar Land, TX 77478

Dear Fenglin Du, PLA, ASLA:

fun abounds is delighted to provide City of Sugar Land with this playground equipment proposal.

This design was developed with your specific needs in mind, and we look forward to discussing this project further with you to ensure your complete satisfaction. fun abounds is confident that this proposal will satisfy City of Sugar Land's functional, environmental, and safety requirements - and most importantly, bring joy and excitement to the children and families directly benefiting from your new playground.

You have our personal commitment to support this project and your organization in every manner possible. We look forward to continuing to develop a long-standing relationship with City of Sugar Land. We appreciate your consideration and value this opportunity to earn your business.

Sincerely,

Leigh Walden  
fun abounds  
130 Venice  
Sugar Land, TX 77478

Proposal # 125-106069-3

## Eldridge Park fun abounds

**Burke®**

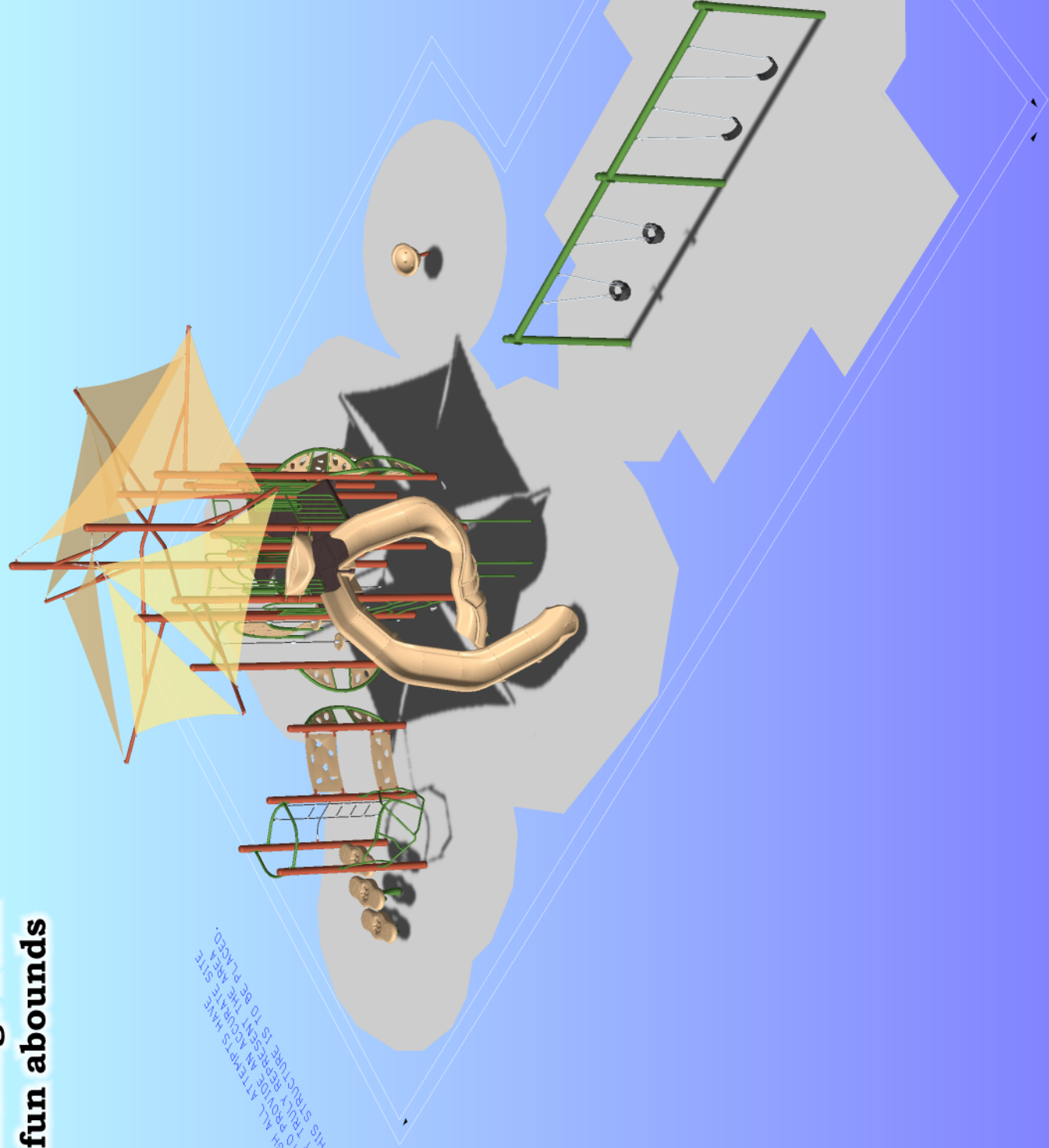

NOTE: ALTHOUGH ALL ATTEMPTS HAVE  
BEEN MADE TO PROVIDE AN ACCURATE SITE  
PLAN, THIS STRUCTURE IS TO BE PLACED  
WHERE THIS STRUCTURE IS TO BE PLACED.

# About fun abounds

## Your local Burke Representative

fun abounds, established in 2007 to serve the park and recreation needs of Houston and Southeast Texas, is passionate about bringing a higher level of play to the communities we serve. We proudly represent some of the industry's top manufacturers that are known for quality and innovation, including BCI Burke Playgrounds, Berliner, USA Shade, Rubber Designs, MyTCoat Site Amenities, StayFit Fitness and Doggie Playsystems. For site planning, general contracting and installation, we've partnered with the area's best crew led by Tom Driscoll at Premier Outdoor Installation. Tom and his team match the passion that we have for play and together we focus on customer satisfaction.

fun abounds is here every step of the way to make certain that your playspace is everything you dreamed. From site analysis to design and installation to maintenance, our entire team is committed to excellence throughout each project and beyond. We are passionate about play and look forward to "creating playground memories filled with fun" for your community.



"creating playground memories filled with fun"





# Testimonials

## West University Place

Susan White - SWhite@westutx.gov

The city of West University Place has worked with fun abounds on numerous projects. Leigh Walden and her team of professionals are a pleasure to work with, and we have found their equipment, service and follow-up to be exemplary.

## City of Friendswood

James Toney - jtoney@ci.friendswood.tx.us

I have worked with Leigh Walden and fun abounds for over 10 years on multiple park projects, with every project turning out perfect. I will always call Leigh and her team first when starting any new projects.

## Brazos Bend Elementary

Rebecca DeVeaux (PTO President 2013-2015) - rebecca@deveaux.cc I had the pleasure of working with fun abounds on the walking path for Brazos Bend Elementary. Leigh Walden and her team worked tirelessly to help me at every step to get this project completed. It was a long process through our MUD boards, which paid for the track, and the school district but Fun Abounds was patient and always there when I needed more information or documentation.

The track itself is fantastic. The kids love walking on it and the staff and parents are thrilled with the safety of the material. No more cut and scraped knees and hands. No more twisted ankles from potholes in the concrete. We could not be more excited to have this new track for our kids. I know it will be there for many years.

Thank you Leigh and fun abounds for all you did to help us. I would be proud to recommend you to any school wishing to make improvements to their facility.



**"I will always call Leigh and her team first when starting any new projects."**

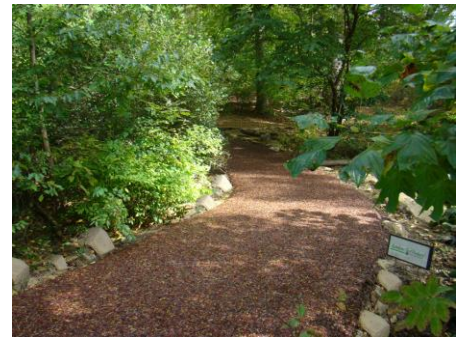

# PLAY THAT MOVES YOU™

Play moves us in a big way and Burke believes our exciting play environments will move you too! Physical movement is the most obvious type, but what about emotional movement that stems from the feeling of pride felt when watching a child accomplish something for the first time? We are moved by social situations when children of all abilities come together to enjoy the childhood staple of play. It moves us to create playgrounds that foster these scenarios and more. Come and move with us!

## Physically

Burke's unique playgrounds feature a fusion of traditional and fitness-based play to get kids moving like never before. Kids get a great workout while having fun! Our combination of traditional and active play events create a space where children of all abilities can play together.

## Cognitively

Research shows that play provides tremendous cognitive developmental benefits to children, including creativity, problem solving, abstract thinking and imagination. There's no such thing as too much of a good thing when it comes to play!

## Socially

Play brings communities together and strengthens families and friendships. Burke's playgrounds provide amazing opportunities for kids to develop socially from playing independently at a young age, transitioning to parallel play and learning how to cooperatively play together as their development continues.

## Emotionally

Creativity and imagination are powerful types of play and a great play environment stimulates these experiences. Burke offers a wide range of themed playgrounds and sensory play events.

## Literally

Movement is essential to life and to play. Motion play creates movement for children of all abilities and assists with many developmental areas, including increased spatial awareness, inner ear stimulation and balance. Motion can be soothing to children with sensory processing differences and offers an interactive activity for everyone to enjoy.



**"THERE'S NO SUCH  
THING AS TOO  
MUCH OF A GOOD  
THING WHEN IT  
COMES TO PLAY!"**





# WORK THAT MOVES US

## Handcrafted by Artisans

Walk through our Fond du Lac, WI manufacturing facility and you will see playgrounds coming to life through the hands of our people. In the age of assembly lines, we work to combine efficiency with a personal touch that makes every playground special. Bringing quality playgrounds to communities like yours is Work That Moves Us, and we hope the playgrounds we make move you too.

## Superior Service

Customer Service is a hallmark of Burke and we take pride in the fact that when you call, we answer. Yes, a real-live person will answer your call and help to direct you to the proper person. We have factory-direct customer service representatives that are available to answer questions, help with replacements parts or field inquiries about installations.

## Your Burke Representative

We as Burke Representatives are passionate about bringing play to your community and helping you design your perfect play environment! We are knowledgeable and experienced about the entire playground process from site evaluation to design to maintenance and will work with you beyond installation to make sure your playground is, and remains, all you dreamed!

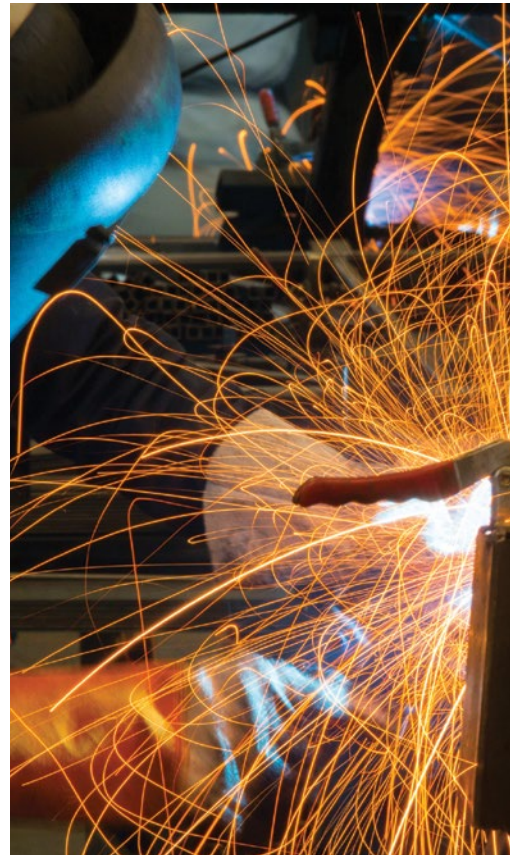

**FROM CONCEPT TO  
REALITY, BURKE  
AND YOUR LOCAL  
REPRESENTATIVE WILL  
WORK CLOSELY WITH  
YOU TO BUILD YOUR  
DREAM PLAYSPACE.**





# BURKE'S HISTORY

John Edward was a farmer in Fond du Lac, WI and farmed the land the Burke company headquarters stands on today. In 1920, he incorporated a weather-stripping company that quickly expanded to include the design and production of designer radiator furniture. After receiving a request to fabricate a slide for a family friend, Burke entered the playground industry! Soon playground products were the company's main focus and they introduced Swing King, a residential line of play equipment.

When World War II began, Burke, like many companies, changed their focus to the war effort. J. E. Burke, always an inventor, devised a self-contained ammunition cart that could be parachuted to army personnel. The Parachute, as it was suitably named, was also used to deliver food and medical supplies. The company's dedication earned special recognition, and in 1943, the J.E. Burke Company was awarded an Excellence in War Production citation. Over the next 40 years, the Burke family grew the business and began to add interesting color and material combinations. In 1972, Burke invented the original Funnel Ball® that became a staple on playgrounds across the country.

In the late 1990's, Greg Burke, grandson of founder J.E. Burke, determined it was time to find a successor to lead the business into the 21st Century. Tim Ahern became the president/CEO of Burke in 1997 and remained until 2015 when Incline Equity Partners invested in Burke and Michael Phelan became the new president/CEO.

Burke remains committed to the original innovation, customer service and superior quality that sustained the company for generations. As we move into 2016 and beyond, we are bringing play to the next level with our focus on "Play That Moves You" and innovating products that move all of us in so many ways.



**TODAY WE CONTINUE TO  
STAND BY J.E. BURKE'S  
ORIGINAL COMMITMENT  
TO SUPERIOR QUALITY,  
OUTSTANDING SERVICE AND  
CONSTANT INNOVATION.**



# BURKE BUILT QUALITY

## Discover the value of investing in a Burke Playground:

**KoreKonnnect® Direct-Bolt Clamp System:** Nucleus and Voltage feature our Industry-leading KoreKonnnect direct-bolt clamp system resulting in the strongest and most accurate connection system ever. Factory located connection points make for easy, precise installation and an error-free fit. Best of all, KoreKonnnect is covered for 100 years under our non-prorated Generations Warranty.

**Direct-Bolt Connection System:** Intensity and Little Buddies feature Burke's trusted direct-bolt connection that uses a durable, straightforward direct-bolt system to ensure a trouble-free installation and provide the necessary strength to accommodate the demands of playing children. Like our KoreKonnnect system, Direct-Bolt connections are covered for 100 years under our Generations Warranty.

**EZKonnnect® Deck Mounting System:** Our exclusive self-leveling deck attachment and factory CNC construction allows for faster and more precise location of decks during installation. The 2-bolt per corner deck attachment increases overall structure strength and stability.

**Platforms:** Burke's oversized non-slip platforms are constructed of heavy-duty punched steel that can support more than two tons. Our vinyl coating is California compliant, free of lead and other hazardous heavy metals.

**Tamper-Resistant Stainless Steel Hardware:** All hardware is covered for 100 years under our Generations Warranty.

**Premium Powder Coatings:** Our industry-leading powder coatings and finishes prevent fading, last longer and deter rust. We also offer a "coastal package" powder coat system. This special powder coat system for metal components and upright posts will provide additional corrosion and chemical protection along with added longevity to the color and gloss retention of the powder coated parts. Contact your Burke Representative for more information on colors, price and warranty.

**Compound Plastics with UV-15:** You'll get long wear and bright, vibrant colors that hold up for years thanks to our thick, durable rotomolded plastics with UV-15 protection. This is why we can cover them for 15 years under our non-prorated Generations Warranty.

**Climbing Cables:** Our climbing cables are flexible enough to provide movement, yet strong enough to last. Our ropes are made from six polyester cords with steel reinforcement wrapped around a synthetic fiber core. Each cord contains eight galvanized steel strands tightly covered with polyester multi-fibers. Our RopeVenture cables consist of six strands, each containing 24 stainless steel reinforcing strands within a nylon sleeve, wrapped around a solid nylon core.

**Aluminum Connectors:** Swivel connectors at the end of our ropes allow assembly at any angle with no unwanted twists in the net. The aluminum fittings used to secure the joints are swaged in place to prevent any movement between the rope and fittings that could cause wear.

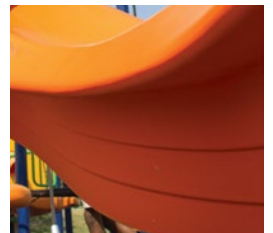



# FREE RESOURCES

## NPPS Safety Kit

Burke truly gives you the most value for your money. As part of our Total Cost of Ownership Package, we offer value-added resources FREE with every playground purchase. The National Program for Playground Safety (NPPS) Playground Supervision Safety Kit helps supervisors and educators be prepared on the playground. Learn more at [bciburke.com/safety](http://bciburke.com/safety).

## Custom Maintenance Kit

To help maintain a safe, functioning playground we include a custom maintenance schedule, touch-up paint, graffiti remover and carrying case FREE with every playground structure purchase.

## Planning & Funding Tools

We provide you with FREE tools to plan your playground from fundraising and design to installing a community build playground. At Burke, we understand the dedication and hard work it takes to raise the funds for playground equipment. That's why we created Funds for Fun, a direct donation fundraising program to help your organization raise the funds it needs for your new playground. We've also partnered with The School Funding Center to provide up-to-date grant information along with expert grant writing services. Learn more at [bciburke.com/funding](http://bciburke.com/funding).



# FEATURED PLAY EVENTS



## Viper Slide

The Viper Slide can't be tamed, but kids love trying! Viper's exciting twisty and fast serpentine action is guaranteed to generate incredible high-energy fun and safe, healthy play.



## Dynamic Pad Climber

The Dynamic Pad Climber challenges children to climb to different heights by building balance and strength while increasing self-confidence.



# FEATURED PLAY EVENTS



## Sprocket Panel

Create the perfect play area for children with Burke's Interactive Play Panels. The play panels encourage exploration, interaction and develop fine-motor skills for children with all abilities.



## Ara Hex Shade

The Ara Shade System provides protection from the sun with 97% UV screen protection and is designed to withstand up to 90mph winds. The addition of Ara can change the entire look of the space and elevate the design to a whole new level!



## KidForce Spinner

The KidForce Spinner provides an exciting motion element on any playground. Using their own weight and momentum, children can spin these unique seats in 360° circle.

# DESIGN SUMMARY

fun abounds is very pleased to present this proposal for consideration for the Eldridge Park located in Sugar Land. BCI Burke Company, LLC has been providing recreational playground equipment for over 90 years and has developed the right mix of world-class capabilities to meet the initial and continuing needs of City of Sugar Land. We believe our proposal will meet or exceed your project's requirements and will deliver the greatest value to you.

The following is a summary of some of the key elements of our proposal:

- Project Name: Eldridge Park
- Project Number: 125-106069-3
- User Capacity: 85
- Age Groups: Ages 2-5 years, 5-12 years
- Dimensions: 74' 1" x 39' 1"
- Designer Name: Kari Champeau

fun abounds has developed a custom playground configuration based on the requirements as they have been presented for the Eldridge Park playground project. Our custom design will provide a safe and affordable playground environment that is aesthetically pleasing, full of fun for all users and uniquely satisfies your specific requirements. In addition, proposal # 125-106069-3 has been designed with a focus on safety, and is fully compliant with ASTM F1487 and CPSC playground safety standards.

We invite you to review this proposal for the Eldridge Park playground project and to contact us with any questions that you may have.

Thank you in advance for giving us the opportunity to make this project a success.



NOTE: ALTHOUGH ALL ATTEMPTS HAVE BEEN MADE TO PROVIDE AN ACCURATE SITE IT MAY NOT TRULY REPRESENT THE AREA WHERE THIS STRUCTURE IS TO BE PLACED.

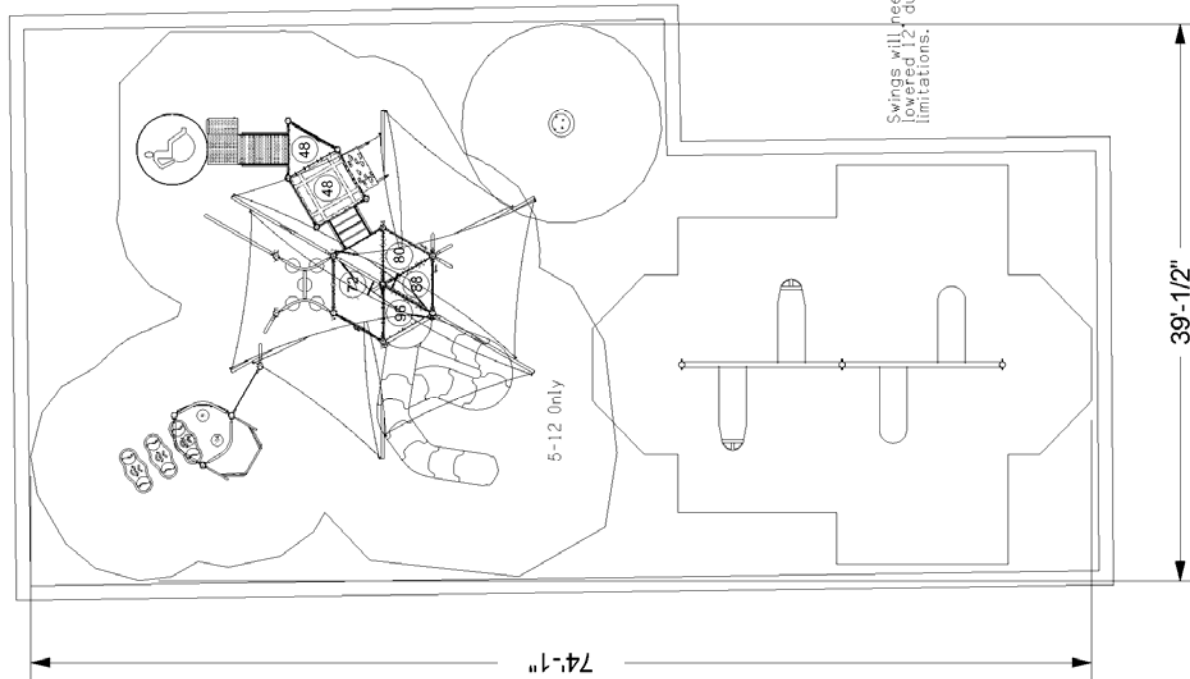

INFORMATION  
MINIMUM FALL ZONE  
SURFACED WITH  
RESILIENT MATERIAL  
AREA

1977 SQ.FT.

PERIMETER

304 FT.

STRUCTURE SIZE

74' 1" x 39' 1"

STRUCTURE IS DESIGNED  
FOR CHILDREN AGES:

- ☐ 6-23 MONTH OLDS  
☒ 2-5 YEAR OLDS  
☒ 5-12 YEAR OLDS  
☐ 13 + YEAR OLDS



To verify product certification,  
visit [www.ipema.org](http://www.ipema.org)

The play components identified  
in this plan are IPEMA  
certified. The use and layout of  
these components conform to the  
requirements of ASTM F1487.  
To verify product certification,  
visit [www.ipema.org](http://www.ipema.org)

The space requirements shown  
here are to ASTM standards.  
Requirements for other standards  
may be different.

The use and layout of play  
components identified in this plan  
conform to the CPSC guidelines.  
U.S. CPSC recommends the  
separation of age groups in  
playground layouts.

## WARNING!

ACCESSIBLE SAFETY SURFACING MATERIAL IS REQUIRED BENEATH  
AND AROUND THIS EQUIPMENT.  
FOR SLIDE FALL ZONE SURFACING AREA SEE CPSC's Handbook for  
Public Playground Safety.  
PLATFORM HEIGHTS ARE IN INCHES ABOVE RESILIENT MATERIAL.

## ADA ACCESSIBILITY GUIDELINE (ADAAG CONFORMANCE)

NUMBER OF PLAY EVENTS:	23
NUMBER OF ELEVATED PLAY EVENTS:	8
NUMBER OF ELEVATED PLAY EVENTS ACCESSIBLE BY RAMP:	PROVIDED: 0
NUMBER OF ELEVATED PLAY EVENTS ACCESSIBLE BY TRANSFER SYSTEM:	PROVIDED: 8
NUMBER OF ELEVATED PLAY EVENTS ACCESSIBLE BY RAMP OR TRANSFER SYSTEM:	PROVIDED: 15
NUMBER OF GROUND LEVEL PLAY EVENTS:	RECD: 3
NUMBER OF TYPES OF GROUND LEVEL PLAY EVENTS:	PROVIDED: 5

**Burke**

SERIES: Basics, Intensity, Nucleus

SITE PLAN

DRAWN BY: Kari Champeau

Eldridge Park

2511 Eldridge Rd

Sugar Land, TX 77478

February 06, 2018

fun abounds

125-106069-3

ITEM	COMP.	DESCRIPTION
1	270-0001	OFFSET ENCLOSURE
2	270-0050	8" CLOSURE PLATE
3	270-0109	PLATFORM LADDER 24"
4	270-0112	UNITARY ENCLOSURE
5	270-0129	TRIANGLE PLATFORM
6	270-0130	SQUARE PLATFORM
7	270-0132	HALF HEXAGON PLATFORM
8	370-0001	AGILITY ARC
9	370-0026	CLIMBER LADDER ROPE CLIMBER
10	370-0467	24" TRANSITION STAIR W/BARRI
11	370-0531	STONE SLOPE CLIMBER 48"
12	370-0712	RUGGED RIDGE
13	370-0714	DYNAMIC PAD CLIMBER, INTENS
14	370-0720	TRANSFER STATION, HANDRAIL
15	370-0763	ODYSSEY DECK LINK
16	370-0813	RIDGE POINT CLIMBER
17	370-0854	VERTO CLIMBER 1
18	370-0865	TREE BRANCH CLIMBER 72"
19	370-1592	PODSTEP CLIMBER 64-72"
20	470-0574	VIPER II OVER UNDER 96
21	470-0678	ARA HEX SHADE CANOPY
22	550-0093	SINGLE POST SWING ASSEMBLY
23	550-0094	SINGLE POST SWING ADD-ON 5'
24	550-0100	TOT SEAT, 7' & 8' PAIR, STD CHA
25	550-0104	BELT SEAT, 7' PAIR, STD CHAIN
26	560-2573	KIDFORCE SPINNER
27	570-0394	PIPE WALL
28	570-0679	SPROCKET PANEL, BELOW PLAT
29	570-1863	RAIN WHEEL PANEL

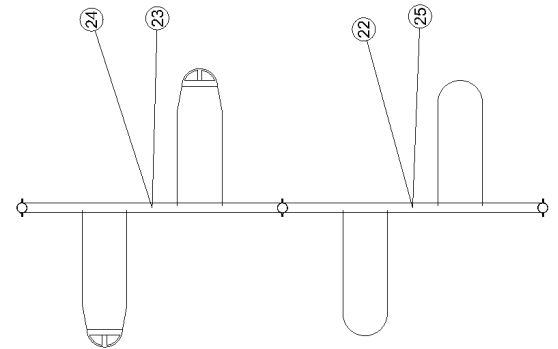
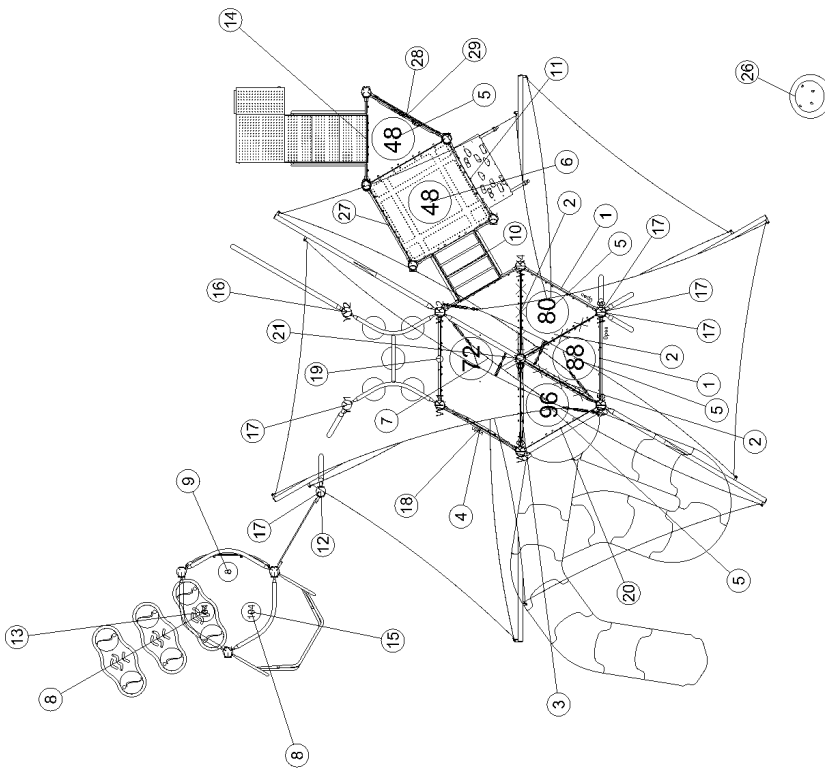

**Burke**

SERIES: Basics, Intensity, Nucleus

COMPONENT PLAN

DRAWN BY: Kari Champeau

Eldridge Park

2511 Eldridge Rd

Sugar Land, TX 77478

February 06, 2018

fun abounds

125-106069-3



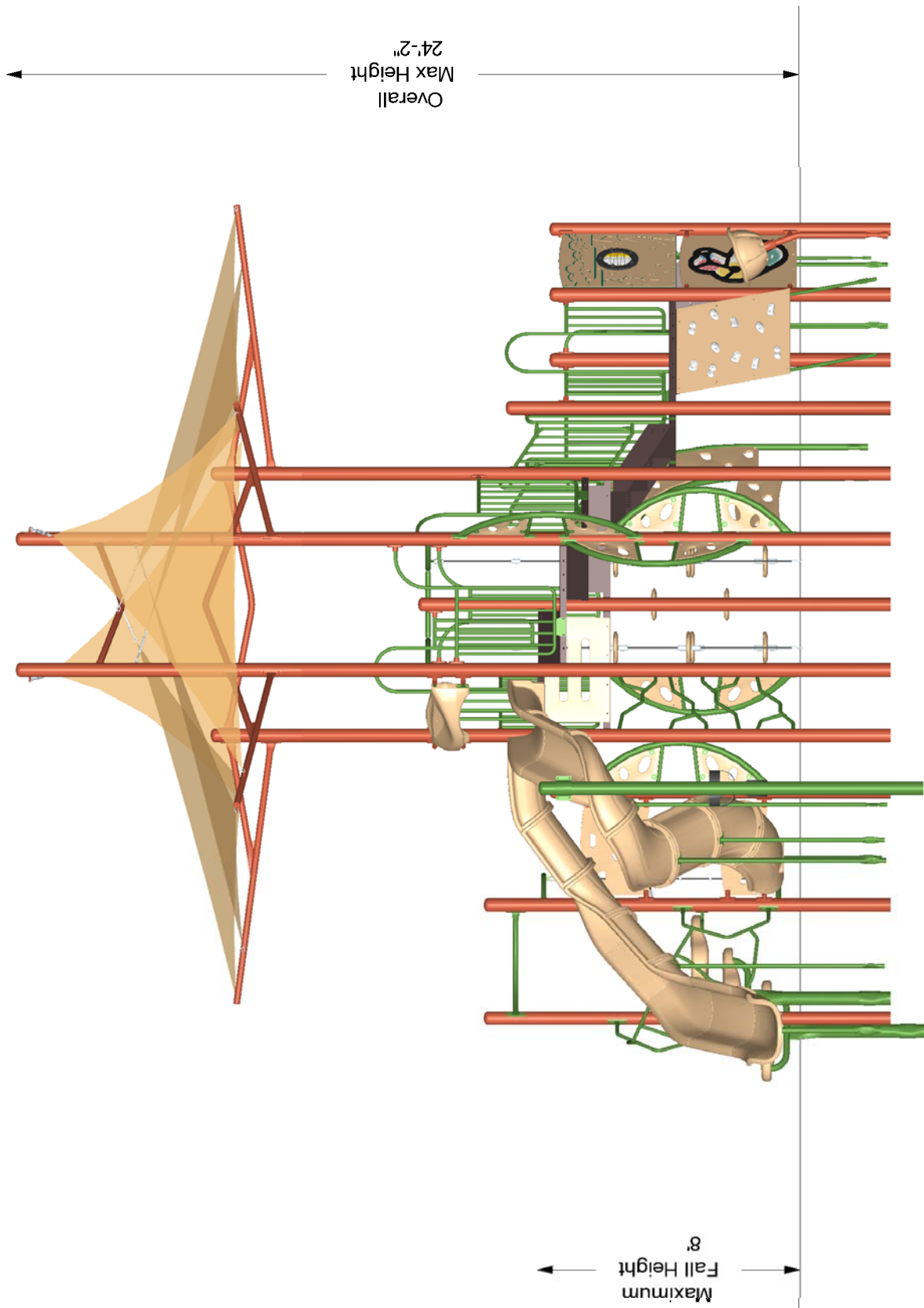

The protective surfacing for this design must accommodate the critical fall height.

**Burke**

February 06, 2018

SERIES: Basics, Intensity, Nucleus

ELEVATION PLAN

DRAWN BY: Kari Champeau

Eldridge Park

2511 Eldridge Rd

Sugar Land, TX 77478

fun abounds

125-106069-3

BCI Burke Company, LLC PO Box 549 Fond du Lac, Wisconsin 54936-0549 Telephone 920-921-9220

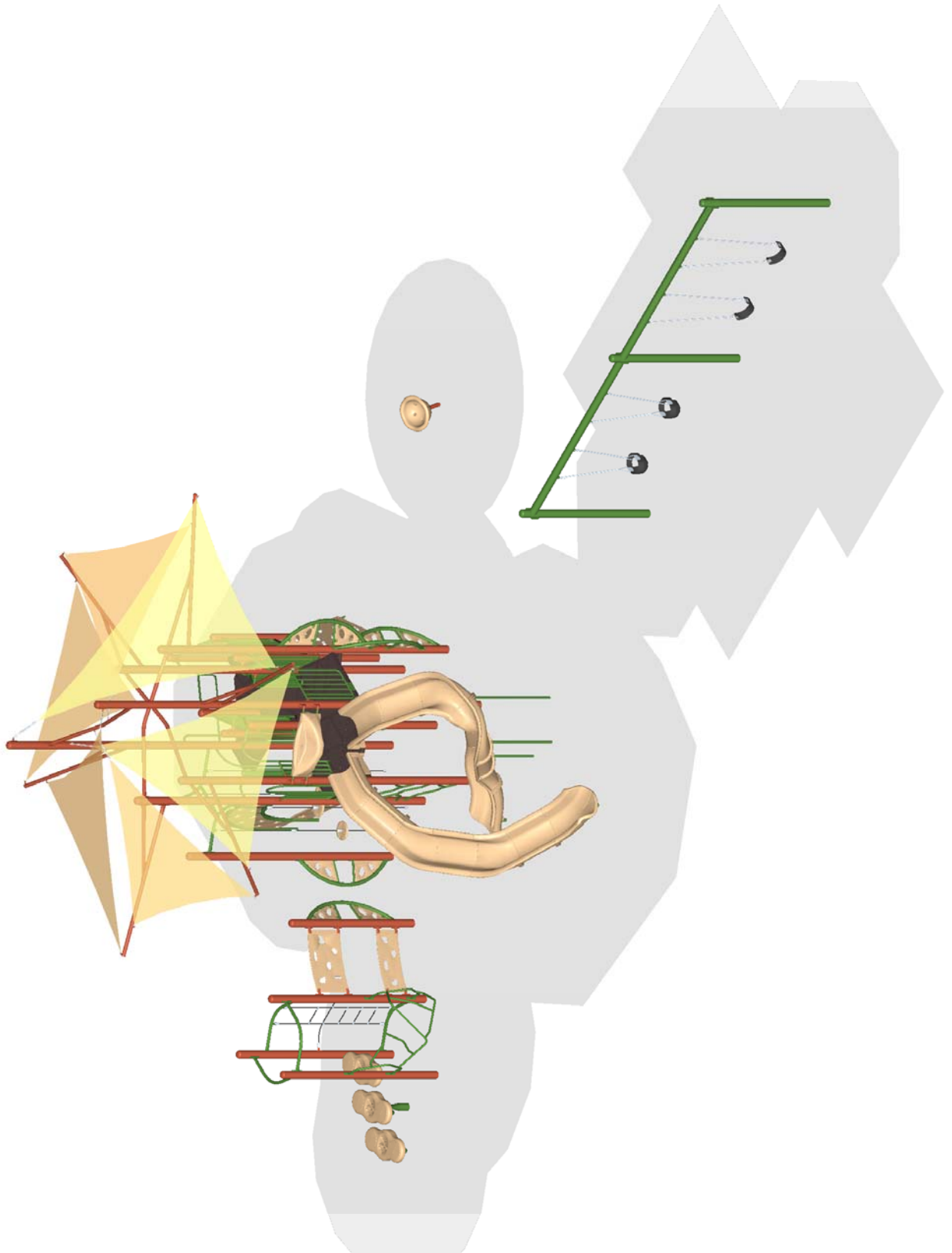

**Burke**

February 06, 2018

SERIES: Basics, Intensity, Nucleus

ISOMETRIC PLAN

DRAWN BY: Kari Champeau

Eldridge Park

2511 Eldridge Rd

Sugar Land, TX 77478

fun abounds

125-106069-3

BCI Burke Company, LLC PO Box 549 Fond du Lac, Wisconsin 54936-0549 Telephone 920-921-9220



# Proposal # 125-106069-3

February 06, 2018  
2018 Pricing

**Proposal Prepared for:**

Fenglin Du, PLA, ASLA  
City of Sugar Land  
10405 Corporate Drive Suite 250  
Sugar Land, TX 77478  
Phone: 281/275-2905

**Project Location:**

Eldridge Park  
2511 Eldridge Rd  
Sugar Land, TX 77478

**Proposal Prepared by:**

fun abounds  
130 Venice  
Sugar Land, TX 77478  
Phone: 281-793-8002  
Fax: 281-265-0043

Leigh Walden  
Phone:  
Fax: 281-265-0043  
lwalden@fabplaygrounds.com

Component No.	Description	Qty.	User Cap.	Ext. User Cap.	Weight	Ext. Weight
Burke Basics						
550-0093	SINGLE POST SWING ASSEMBLY 5"...	1	2	2	237	237
550-0094	SINGLE POST SWING ADD-ON 5" OD	1	2	2	154	154
550-0100	TOT SEAT, 7' & 8' PAIR, STD ...	1	0	0	23	23
550-0104	BELT SEAT, 7' PAIR, STD CHAIN	1	0	0	17	17
560-2573	KIDFORCE SPINNER	1	1	1	43	43
Intensity						
370-0001	AGILITY ARC	2	1	2	11	22
370-0026	LIMBER LADDER ROPE CLIMBER	1	1	1	33	33
370-0712	RUGGED RIDGE	1	2	2	34	34
370-0714	DYNAMIC PAD CLIMBER, INTENSITY	1	3	3	142	142
Nucleus						
270-0001	OFFSET ENCLOSURE	2	1	2	30	60
270-0050	8" CLOSURE PLATE	3	0	0	10	30
270-0109	PLATFORM LADDER 24"	1	1	1	65	65
270-0112	UNITARY ENCLOSURE	1	0	0	34	34
270-0129	TRIANGLE PLATFORM	4	2	8	48	192
270-0130	SQUARE PLATFORM	1	6	6	106	106
270-0132	HALF HEXAGON PLATFORM	1	6	6	144	144
370-0467	24" TRANSITION STAIR W/BARRIE...	1	2	2	164	164
370-0531	STONE SLOPE CLIMBER 48"	1	2	2	101	101
370-0720	TRANSFER STATION, HANDRAIL 48"	1	6	6	236	236
370-0763	ODYSSEY DECK LINK	1	4	4	40	40
370-0813	RIDGE POINT CLIMBER	1	4	4	162	162
370-0854	VERTO CLIMBER 1	5	1	5	35	175
370-0865	TREE BRANCH CLIMBER 72"	1	4	4	33	33
370-1592	PODSTEP CLIMBER 64-72"	1	10	10	125	125
470-0574	VIPER II OVER UNDER 96	1	8	8	479	479
470-0678	ARA HEX SHADE CANOPY	1	0	0	576	576
570-0394	PIPE WALL	1	0	0	36	36
570-0679	SPROCKET PANEL, BELOW PLATFORM	1	2	2	65	65
570-1863	RAIN WHEEL PANEL	1	2	2	59	59
600-0104	NPPS SUPERVISION SAFETY KIT	1	0	0	3	3
670-0099	INSTALLATION KIT, INTENSITY	1	0	0	2	2
670-0103	MAINTENANCE KIT, INTENSITY	1	0	0	0	0
670-0158	POST ASSEMBLY 5" OD X 184"	2	0	0	97	194





## Proposal # 125-106069-3

February 06, 2018

2018 Pricing

670-0163	POST, SWAGED ROOF 5" OD X 220"	6	0	0	115	690
670-0165	POST ASSEMBLY 5" OD X 123"	4	0	0	66	264
670-0166	POST ASSEMBLY 5" OD X 139"	2	0	0	74	148
670-0167	POST ASSEMBLY 5" OD X 147"	3	0	0	78	234
670-0169	POST ASSEMBLY 5" OD X 171"	1	0	0	91	91

Total User Capacity: 85

Total Weight: 5,213 lbs.

Total Price: \$56,984

Information is relative to the Feb 6 2018 4:35AM database.

### Special Notes:

Prices do not include freight, unloading, material storage, site excavation/preparation, removal of existing equipment, removal of excess soil from footing holes, site security, safety surfacing, installation, or sales tax (if applicable). Prices are based on standard colors per CURRENT YEAR BCI Burke Catalog. Custom colors, where available, would be an extra charge. **Pricing is valid for 45 days from the date of this proposal.**



fun abounds, inc.  
114 Venice  
Sugar Land, TX. 77478  
855-226-8637 phone  
281-265-0043 Fax  
Leigh Walden, President  
lwalden@fabplaygrounds.com  
www.fabplaygrounds.com

## Estimate

Date	Estimate #
2/7/2018	3913

Lindsay Bowerman  
Business Development Manager  
lindsay@fabplaygrounds.com  
832-808-1537

We are pleased to provide this estimate for

City of Sugar Land  
Parks and Rec Dept.  
PO Box 1110  
Sugar Land, TX 77478

Ship to:

tbd

Rep

Terms

Project

LB

30% deposit requ...

Eldridge Park

Item	Description	Qty	Rate	Total
Buyboard Number Burke	Buyboard 512-16 BCI Burke Custom Playground See drawing 125-106069-3	1	0.00 56,984.00	0.00 56,984.00
Installation	Installation of the above equipment	1	13,708.50	13,708.50
Freight	Freight	1	4,325.17	4,325.17
Top Off	Top Off of Engineered Wood Fiber - 50 yard minimum	53	49.50132	2,623.57
Discount	Discount Buyboard		-2,849.20	-2,849.20
Bonding Cost	Bonding Cost	1	2,432.48	2,432.48
Removal	Removal of current equipment & Demo	1	2,000.00	2,000.00

Thank you for allowing us to be a part of your project.

**Subtotal**

**PLEASE NOTE: Order will be placed upon receipt of signed quote or  
purchase order, color selections, and down payment.**

**Thank you! We appreciate the opportunity to earn your business!**

**Sales Tax..**

**Total**

City of Houston WBE  
(Women's Business Enterprise)  
Certificate #12-12-11596

Signature

**We are proud of a job well done and may spotlight your project on our  
website or FaceBook. If we do not have your permission to do so,  
please notify us. Thank you!**



fun abunds, inc.  
114 Venice  
Sugar Land, TX. 77478  
855-226-8637 phone  
281-265-0043 Fax  
Leigh Walden, President  
lwalden@fabplaygrounds.com  
www.fabplaygrounds.com

## Estimate

Date	Estimate #
2/7/2018	3913

Lindsay Bowerman  
Business Development Manager  
lindsay@fabplaygrounds.com  
832-808-1537

We are pleased to provide this estimate for

City of Sugar Land  
Parks and Rec Dept.  
PO Box 1110  
Sugar Land, TX 77478

Ship to:

tbd

Rep

Terms

Project

LB

30% deposit requ...

Eldridge Park

Item	Description	Qty	Rate	Total
Note	Pricing is for the above listed equipment only, and does not include additional insured addendum, additional insurance, storage, security, or any applicable taxes, bonds, additional insurance or permits. Orders canceled after 5 days will be subject to a restocking fee and freight charges as applicable. Price valid for 30 days.		0.00	0.00
Credit Cards	Payments made with credit cards (Visa and Mastercard only) will require an additional 3% service fee.		0.00	0.00
Finance Charge	Accounts not paid within 30 days of the date of the invoice are subject to a 1.5% finance charge.		0.00	0.00
Nondisclosed underground	We make every effort to ensure that we are working in areas free of utilities. In the event an object is disturbed or damaged and the client has failed to make us aware of their utilities it will be the Client's responsibility.		0.00	0.00

Thank you for allowing us to be a part of your project.

**Subtotal**

**PLEASE NOTE: Order will be placed upon receipt of signed quote or purchase order, color selections, and down payment.**

**Thank you! We appreciate the opportunity to earn your business!**

**Sales Tax..**

**Total**

City of Houston WBE  
(Women's Business Enterprise)  
Certificate #12-12-11596

Signature

**We are proud of a job well done and may spotlight your project on our website or FaceBook. If we do not have your permission to do so, please notify us. Thank you!**





fun abounds, inc.  
114 Venice  
Sugar Land, TX. 77478  
855-226-8637 phone  
281-265-0043 Fax  
Leigh Walden, President  
lwalden@fabplaygrounds.com  
www.fabplaygrounds.com

## Estimate

Date	Estimate #
2/7/2018	3913

Lindsay Bowerman  
Business Development Manager  
lindsay@fabplaygrounds.com  
832-808-1537

We are pleased to provide this estimate for		Ship to:		
City of Sugar Land Parks and Rec Dept. PO Box 1110 Sugar Land, TX 77478		tbd		
		Rep	Terms	Project
		LB	30% deposit requ...	Eldridge Park
Item	Description	Qty	Rate	Total
Schedule	There are times due to weather or unforeseen circumstances that we might have to reschedule. In an effort to provide excellent customer service we will notify you should rescheduling be necessary. We appreciate your understanding as we pride ourselves on providing attention and detail to every project.		0.00	0.00
Thank you for allowing us to be a part of your project.			<b>Subtotal</b>	\$79,224.52
<b>PLEASE NOTE: Order will be placed upon receipt of signed quote or purchase order, color selections, and down payment.</b> <b>Thank you! We appreciate the opportunity to earn your business!</b>			<b>Sales Tax..</b>	\$0.00
			<b>Total</b>	\$79,224.52
<div style="border: 1px dashed red; padding: 5px; width: fit-content;">                 City of Houston WBE (Women's Business Enterprise) Certificate #12-12-11596             </div>		Signature _____		
<p><b>We are proud of a job well done and may spotlight your project on our website or FaceBook. If we do not have your permission to do so, please notify us. Thank you!</b></p>				



## Proposal # 125-106069-3

February 06, 2018  
2018 Pricing

### ***Selected Color List***

<b><u>Color Group</u></b>	<b><u>Color</u></b>
<i>Phase 1</i>	
Accessory	Olive
Platform	Brown
Kore Konnect	Redwood
Rotomolded	Tan
1 Color Extruded/Flat	Tan
Post	Redwood
Intensity/Rocky Mountain	Tan
2 Color Extruded/Flat (outer)	Tan
2 Color Extruded/Flat (inner)	Green
Chimes/Sprocket Main Panel & Cruiser Seat Backs	Tan
Chimes Note/Sprocket Overlay & Cruiser Side Panels	Black
<i>Phase 2</i>	
Contemporary Swing Fittings	Olive
Rotomolded	Tan
Post	Redwood

# COLORS THAT MOVE YOU

## HDPE PLASTIC PANELS



## POWDER COAT PAINT



## SHADE CANOPIES

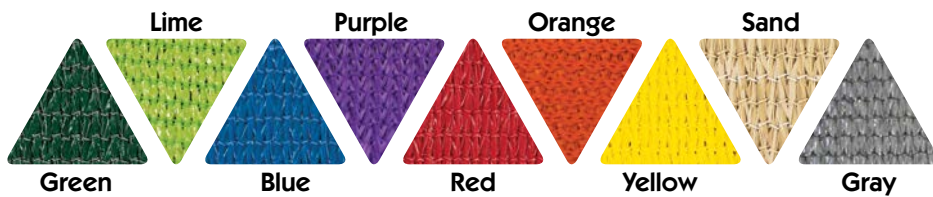

## PLATFORMS

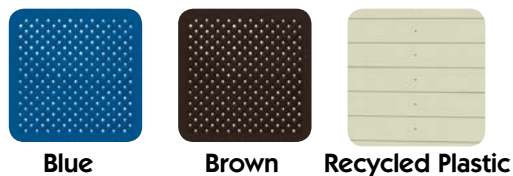

## ROCKIT CLIMBERS

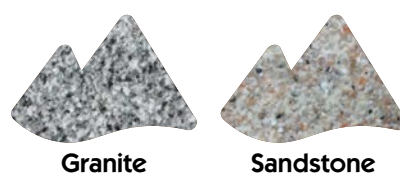

## ROTOMOLD PLASTIC

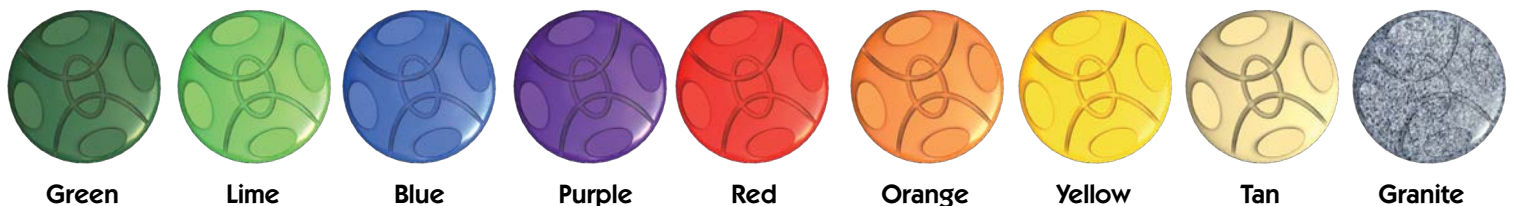

VISIT [BCIBURKE.COM/COLORSELECTION](http://BCIBURKE.COM/COLORSELECTION) TO CUSTOMIZE YOUR PLAYGROUND COLORS!



# TESTIMONIALS

*"Service, Safety, Quality. Three words I would use to describe the people, business model, and overall organizational standards that inspires the BCI Burke Company. Every organization has a unique set of challenges and goals when it comes to building an educational environment - and from our experience, BCI Burke came to the table ready to work with us as partners to meet those challenges and goals head on.*

*We chose to work with BCI Burke because we needed a reliable company that would be able to provide nothing less than the highest quality product with our own time limitations. As with most other businesses, we did not have the luxury of making an investment into a project of this magnitude and not feel 100% certain that we had gotten the very best of our dollar. We also had to assure our stakeholders that we would see that investment last the test of time.*

*BCI Burke offered us superb and consistent customer service, the ability to achieve our goal on a fast timetable, and the confidence that our playground is genuinely the very best in design and safety. This is something that we will showcase in our school for many years to come.*

*After working with the company, I know personally they are committed to go the extra mile to satisfy your needs. BCI Burke is a master in their field but also provide the customer with an intuitive understanding of service".*

Angela H. Brunini  
Principal  
St. Anthony Catholic School

*"I am writing to tell you how much I enjoyed and appreciated working with your local representative...Through the years, I have worked with a number of playground companies, but never with anyone with the professionalism, commitment and follow-through of (your Burke Rep). We are all so excited about our children having the opportunity to play on your wonderful equipment; of course, we want everything! We are so impressed with the many, many possible designs. Thank you for the quality of your equipment and your local representatives."*

Nancy Emerson  
Director  
The Children's Center  
Dallas , TX

# BCI BURKE GENERATIONS WARRANTY®

## The Longest and Strongest warranty in the industry

BCI Burke Company, LLC ("Burke") warrants that all standard products are warranted to be free from defects in materials and workmanship, under normal use and service, for a period of one (1) year from the date of invoice.

### We stand behind our products.

In addition, the following products are warranted, under normal use and service from the date of invoice as follows:

- One Hundred (100) Year Limited Warranty on aluminum and steel upright posts (including Intensity®, Voltage®, Nucleus®, Little Buddies® and ELEVATE™/ACTIVATE™) against structural failure due to corrosion, deterioration or workmanship.
- One Hundred (100) Year Limited Warranty on KoreKconnect® clamps against structural failure due to corrosion, deterioration or workmanship.
- One Hundred (100) Year Limited Warranty on Hardware (nuts, bolts, washers)
- One Hundred (100) Year Limited Warranty on bolt-through fastening and clamp systems (Voltage®, Intensity®, Nucleus®, Little Buddies® and ELEVATE™/ACTIVATE™).
- Twenty-Five (25) Year Limited Warranty on spring assemblies and aluminum cast animals.
- Fifteen (15) Year Limited Warranty on main structure platforms and decks, metal roofs, table tops, bench tops, railings, loops and rungs.
- Fifteen (15) Year Limited Warranty on all plastic components including StoneBorders against structural failure due to materials or workmanship.
- Ten (10) Year Limited Warranty on ShadePlay Canopies fabric, threads, and cables against degradation, cracking or material breakdown resulting from ultra-violet exposure, natural deterioration or manufacturing defects. This warranty is limited to the design loads as stated in the specifications.
- Ten (10) Year Limited Warranty on NaturePlay® Boulders and GFRC products against structural failure due to natural deterioration or workmanship. Natural wear, which may occur with any concrete product with age, is excluded from this warranty.
- Ten (10) Year Limited Warranty on Full Color Custom Signage against manufacturing defects that cause delamination or degradation of the sign. Full Color Custom Signs also carry a two (2) year warranty against premature fading of the print and graphics on the signs.
- Five (5) Year Limited Warranty on Intensity® and RopeVenture® cables against premature wear due to natural deterioration or manufacturing defects. Determination of premature wear will be at the manufacturer's discretion.
- Five (5) Year Limited Warranty on swing seats and hangers; Kid Koaster® Trolleys and other moving parts against structural failure due to materials or workmanship.
- Three (3) Year Limited Warranty on electronic panel speakers, sound chips and circuit boards against electronic failure caused by manufacturing defects.

The warranty stated above is valid only if the equipment is erected in conformity with the layout plan and/or installation instructions furnished by BCI Burke Company, LLC using approved parts; have been maintained and inspected in accordance with BCI Burke Company, LLC instructions. Burke's liability and your exclusive remedy hereunder will be limited to repair or replacement of those parts found in Burke's reasonable judgment to be defective. Any claim made within the above stated warranty periods must be made promptly after discovery of the defect. A part is covered only for the original warranty period of the applicable part. Replacement parts carry the applicable warranty from the date of shipment of the replacement from Burke. After the expiration of the warranty period, you must pay for all parts, transportation and service charges.

Burke reserves the right to accept or reject any claim in whole or in part. Burke will not accept the return of any product without its prior written approval. Burke will assume transportation charges for shipment of the returned product if it is returned in strict compliance with Burke's written instructions.

**THE FOREGOING WARRANTIES ARE EXCLUSIVE AND IN LIEU OF ANY OTHER WARRANTY, EXPRESS OR IMPLIED, INCLUDING BUT NOT LIMITED TO ANY IMPLIED WARRANTY OR MERCHANTABILITY OR FITNESS FOR A PARTICULAR PURPOSE. IF THE FOREGOING DISCLAIMER OF ADDITIONAL WARRANTIES IS NOT GIVEN FULL FORCE AND EFFECT, ANY RESULTING ADDITIONAL WARRANTY SHALL BE LIMITED IN DURATION TO THE EXPRESS WARRANTIES AND BE OTHERWISE SUBJECT TO AND LIMITED BY THE TERMS OF BURKE'S PRODUCT WARRANTY. SOME STATES DO NOT ALLOW THE EXCLUSION OF CERTAIN IMPLIED WARRANTIES, SO THE ABOVE LIMITATION MAY NOT APPLY TO YOU.**

**Warranty Exclusions:** The above stated warranties do not cover: "cosmetic" defects, such as scratches, dents, marring, or fading; damage due to incorrect installation, vandalism, misuse, accident, wear and tear from normal use, exposure to extreme weather; immersion in salt or chlorine water, unauthorized repair or modification, abnormal use, lack of maintenance, or other cause not within Burke's control; and

**Limitation of Remedies:** Burke is not liable for consequential or incidental damages, including but not limited to labor costs or lost profits resulting from the use of or inability to use the products or from the products being incorporated in or becoming a component of any other product. If, after a reasonable number of repeated efforts, Burke is unable to repair or replace a defective or nonconforming product, Burke shall have the option to accept return of the product, or part thereof, if such does not substantially impair its value, and return the purchase price as the buyer's entire and exclusive remedy. Without limiting the generality of the foregoing, Burke will not be responsible for labor costs involved in the removal of products or the installation of replacement products. Some states do not allow the exclusion of incidental damages, so the above exclusion may not apply to you.

Contact your local Burke Representative for warranty information regarding Burke Turf® and Burke Tile products.

### Terms of Sale

**Pricing:** Prices published in this catalog are in USD, are approximate and do not include shipping & handling, surfacing, installation nor applicable taxes. All prices are subject to change without notice. Contact your Burke representative for current pricing. Payments are to be made in USD.

**Weights:** Weights are approximate and may vary with actual orders.

**Installation:** All equipment is shipped unassembled. For a list of factory-certified installers in your area, please contact your Burke representative.

**Specifications:** Product specifications in this catalog were correct at the time of publication. However, product improvements are ongoing at Burke, and we reserve the right to change or discontinue specifications without notice.

**Loss or Damage in Transit:** A signed bill of lading is our receipt from a carrier that our shipment to you was complete and in good condition upon arrival. Before you sign, please check the Bill of Lading carefully when the shipment arrives to make sure nothing is missing and there are no damages. Once the shipment leaves our plant, we are no longer responsible for any damage, loss or shortage.

**For more information regarding the warranty, call Customer Service at 920-921-9220 or 1-800-356-2070.**

**01/2018**