

DONATION AGREEMENT

This Donation Agreement is made by and between the **CITY OF SUGAR LAND** and **LCFRE SUGAR LAND TOWN SQUARE, LLC**.

WHEREAS, LCFRE Sugar Land Town Square, LLC (LCFRE) desires to install two electronic LED signs, with related wiring, electrical components and fixtures, equipment, and other appurtenances and improvements (Electronic Sign Improvements), within the right-of-way of City Walk Drive in Sugar Land Town Square, as described and shown in Exhibit A, and located as shown in Exhibit A; and

WHEREAS, the Sugar Land 4B Corporation (SL4B) may, but is not required to, fund up to one-half the value of the Electronic Sign Improvements pursuant to a Development Agreement among the SL4B, LCFRE, and the Sugar Land Town Square Property Owners' Association, Inc. (SLTSPOA) regarding the installation and construction of Plaza Improvements, Plaza WiFi Improvements, Plaza Sound Improvements, Personal Property, and Electronic Sign Improvements, as those terms are defined in the Development Agreement; and

WHEREAS, LCFRE desires to donate all of its interest in and to the Electronic Sign Improvements to the City pursuant to this Donation Agreement; and

WHEREAS, the Electronic Sign Improvements will be installed as part of the Sugar Land Town Square Plaza Improvements, Plaza WiFi Improvements, Personal Property, and Plaza Sound Improvements installed and constructed pursuant to the Development Agreement; and

WHEREAS, installation and construction of the Electronic Sign Improvements is subject to the Architectural Review Committee of First Colony Property Owners' Association, Inc. (FCPOA) approving the Electronic Sign Improvements as being in compliance with the Sugar Land Town Square Development Guidelines and restrictive covenants applicable to Sugar Land Town Square; and

WHEREAS, installation and construction of the Electronic Sign Improvements is subject to the SLTSPOA determining that City Walk Drive is part of the Common Area under the Declaration for Sugar Land Town Square recorded in File No. 2002020602, Fort Bend County, Texas Official Public Records (Town Square Declaration), for which the SLTSPOA has authority to maintain and repair the Electronic Sign Improvements as "signage, whether decorative or otherwise"; and

WHEREAS, the City Council has approved the Criteria for Donation of Items for Sugar Land Town Square pursuant to Resolution No. 04-30 adopted on August 17, 2004 (Donation Policy); and

WHEREAS, the donation of the Electronic Sign Improvements will meet the requirements of the Donation Policy; **NOW, THEREFORE**,

I. Definitions

Agreement means this Donation Agreement between the City and Developer.

City means the City of Sugar Land, Texas, a home-rule city of the State of Texas.

Consent Agreement means the Consent Agreement among the City, the Development Authority and the SL4B regarding the Electronic Sign Improvements, Plaza Improvements, Plaza Sound Improvements, Plaza WiFi Improvements, and Personal Property.

Declaration means the Declaration for Sugar Land Town Square recorded in File No. 2002020602, Fort Bend County, Texas Official Public Records.

Developer means LCFRE Sugar Land Town Square, LLC, a Delaware limited liability company.

Development Agreement means a development agreement among the SL4B, the Developer, and the SLTSPOA regarding installation and construction of the Plaza Improvements, Plaza Sound Improvements, Plaza WiFi Improvements, and Electronic Sign Improvements.

Development Authority means the Sugar Land Town Square Development Authority, a Texas local government corporation created pursuant to Chapter 431, Subchapter D of the Texas Transportation Code.

Donation Policy means the City Council Policy regarding Donations for Sugar Land Town Square adopted pursuant to Resolution No. 04-30, a copy of which is attached as Exhibit B.

Electronic Sign Improvements means the two electronic LED signs and associated wiring, electrical components and fixtures, equipment, and other appurtenances and improvements, which are described and shown in Exhibit A.

FCPOA means First Colony Property Owners' Association, Inc., a Texas non-profit corporation.

Personal Property means the furniture for the Plaza consisting of tables and chairs, the styles of which are approved pursuant to the Consent Agreement.

Plans and Specifications means the plans and specifications for the Electronic Sign Improvements, as shown in Exhibit A.

Plaza means the Sugar Land Town Square Plaza conveyed to the Development Authority by Special Warranty Deed recorded in File No. 2002020614 of the Fort Bend County, Texas Official Public Records.

Plaza Improvements means the improvements to be installed and constructed within the Plaza, according to the Development Agreement.

SL4B means the Sugar Land 4B Corporation, a non-profit corporation created by the City to promote economic development activities as authorized by then section 4B of the Development Corporation Act of 1979, Tex. Rev. Civ. Stat. Ann. Art. 5190.6, currently codified as Chapters 501 through 505, Tex. Local Gov't Code.

SLTSPOA means the Sugar Land Town Square Property Owners' Association, Inc., a Texas non-profit corporation.

Sugar Cane Structures means the sugar cane monument structures shown in Exhibit A.

II. Conditions for Donation

2.1 Developer Requirements. The Developer agrees that:

- (a) Its donation of all of its right, title and interest in and to the Electronic Sign Improvements to the City will comply with the Donation Policy.
- (b) The estimated value of its right, title and interest in and to the Electronic Sign Improvements is \$75,000.
- (c) At a minimum, the Electronic Sign Improvements must meet the following standards:
 - (1) Each Electronic Sign Improvement must be capable of having a minimum length of display for messages to be at least (i) ten seconds if relating to traffic or general safety as determined by the City; and (ii) eight seconds for all other messages.
 - (2) Each Electronic Sign must be capable of providing consecutive messages change in two seconds or less.
 - (3) Each Electronic Sign must not contain animation, full motion video, flashing lights, scrolling messages, moving light, spotlights or blinking lights.
 - (4) Each Electronic Sign must meet the requirements of all applicable rules, laws, nationally recognized standards, including the Texas Manual on Uniform Traffic Control Devices, National Transportation communications for its protocol, and underwriters laboratories.
 - (5) Each Electronic Sign must be capable of displaying emergency information, including information about traffic safety, terrorist attacks, natural disasters and amber alerts.

- (6) The brightness of each Electronic Sign must be capable of not exceeding 0.3 foot candles above ambient light conditions at a distance of 250 feet.
- (7) Each Electronic Sign must have safety mechanisms in place that include the following:
 - 1. Containing a default mechanism that freezes the Electronic Sign in one position if a malfunction occurs;
 - 2. Automatically adjusting the intensity of the display according to natural ambient light conditions;
 - 3. Capability of reduction of intensity to a level that will not cause impairment of a motor vehicle driver's vision or will not interfere with the operation of a motor vehicle.
- (d) It will obtain from the FCPOA a letter addressed to the City's attention under which the FCPOA:
 - (1) Confirms that the Electronic Sign Improvements will comply with the requirements of the Sugar Land Town Square Development Guidelines and restrictive covenants applicable to Sugar Land Town Square;
 - (2) Recommends that the SLTSPOA accept the Electronic Sign Improvements for maintenance and repair;
 - (3) Recommends that the City accept the Electronic Sign Improvements; and
 - (4) Confirms that the City will not be subject to assessments associated with the Electronic Sign Improvements under the restrictive covenants applicable to Sugar Land Town Square.
- (e) The City will not accept the donation until the City Manager has determined that the Electronic Sign Improvements have been installed and constructed in compliance with the City's ordinances, permits, and the Development Agreement.
- (f) LCFRE must assign and transfer unto the City all of LCFRE's right, title and interest in and to (ii) all tests, renderings, Plans and Specifications, and other plans, diagrams or studies of any kind, if any, now or hereafter in the possession of LCFRE and which relate to the Electronic Sign Improvements, (iii) any keys and codes to the Electronic Sign Improvements, and (iii) all contract and manufacturer warranties pertaining to the Electronic Sign Improvements. LCFRE must provide a copy of the foregoing documents and information to the SLTSPOA.
- (g) The Donation of the Electronic Sign Improvements will be evidenced by the Developer's signature on the form of the Donation of Electronic Sign Improvements attached as Exhibit C.

III. Miscellaneous

3.1 Effective Date. This Agreement begins on the effective date of the Consent Agreement and ends on the date of the City Manager's execution of the form Donation of Electronic Sign Improvements attached as Exhibit D.

3.2 Changes to Agreement. This Agreement may not be modified, changed, amended, supplemented or terminated, except by written instrument signed by all parties hereto.

3.3 Governing Law. This Agreement is governed by, interpreted under, and construed and enforced in accordance with, the laws of the State of Texas.

3.4 Counterparts. This Agreement may be executed in any number of counterparts, each of which shall be deemed an original and all of which counterparts together shall constitute one agreement with the same effect as if the parties had signed the same signature page.

3.5 Disclosure of Interested Persons for Council-Approved Contracts. Contracts that require City Council approval are subject to the requirements of Section 2252.908, Tex Gov't Code. Under the provisions of this statute:

(1) The City may not enter into a contract with a business entity that requires Council approval unless the business entity submits a disclosure of interested persons at the time the business entity submits a signed contract to the City;

(2) A disclosure of interested parties must be submitted on a form prescribed by the Texas Ethics Commission (Commission) that includes:

- (a) A list of each interested party for the contract of which the contractor business entity is aware, an interested party being a person who has a controlling interest in the business entity or who actively participates in facilitating or negotiating the terms of the contract, including a broker, intermediary, adviser, or attorney for the business entity; and
- (b) The signature of the authorized agent of the contracting business entity, acknowledging that the disclosure is made under oath and under penalty of perjury.

The Commission has approved a Certificate of Interested Persons form, which must be filled out, signed and notarized by the Contractor and submitted to the City at the time of execution of this Agreement, along with the certification of filing generated from the Commission's website at <https://www.ethics.state.tx.us/tec/1295-Info.htm>. The Certificate of Interested Persons form is available on the Commission's website and the Contractor must follow the Commission's filing process adopted pursuant to the statute.

3.6 Prohibition on Contracts with Companies Boycotting Israel. Contracts for goods and services are subject to the requirements of Section 2270.002, Tex Gov't Code (H.B. 89). Under the

provisions of this statute, the City may not enter into a contract with a company for goods and services unless the contract contains a written verification from the company that it:

- (1) Does not boycott Israel; and
- (2) Will not boycott Israel during the term of the contract.

The City has approved a verification form, which must be filled out and signed by the Contractor and submitted to the City at the time of execution of this Agreement.

3.7 Exhibits. The following exhibits are attached to and incorporated into this Agreement:

Exhibit A—Electronic Sign Improvements

Exhibit B—Donation Policy

Exhibit C—Form of Donation of Electronic Sign Improvements

[Signature page follows]

CITY OF SUGAR LAND

**LCFRE SUGAR LAND
TOWN SQUARE, LLC**

Allen Bogard, City Manager

Name: _____
Title: _____

Date: _____

Date: _____

ATTEST:

ATTEST:

Thomas Harris
Assistant City Secretary

Name: _____
Title: _____

EXHIBIT A
Electronic Sign Improvements

SIGN TYPE A

QUANTITY: 2

REMOVE AND DISPOSE OF PRINT ADS ON ONE SIDE OF TWO EXISTING FOUR SIDED STRUCTURES
REPLACE WITH NEW SIGNS AS NOTED

FABRICATE AND INSTALL SINGLE FACED LED DISPLAYS AND SINGLE FACED CABINETS
ONTO TWO EXISTING FOUR SIDED STRUCTURES
- ONE DISPLAY & TWO INTERNALLY ILLUMINATED CABINETS PER STRUCTURE

INTERNALLY ILLUMINATED CABINETS: ALL ALUMINUM FABRICATION PAINTED P1 - ALL GRAPHICS: ROUTED INTO FACE AND BACKED WITH 3/16" 7328 WHITE ACRYLIC WITH V1 VINYL APPLIED INTERNALLY ILLUMINATED WITH WHITE LEDS
FLUSH MOUNTED TO EXISTING GRANITE CLAD STRUCTURE

LED DISPLAY:
• 144 X 216 FULL COLOR LED MATRIX (10mm PIXEL PITCH)
• 5' - 2" HIGH X 7' - 7" WIDE CABINET
• 4' - 10" HIGH X 7'-2" WIDE DISPLAY AREA
• FULLY PROGRAMABLE GRAPHICS AND TEXT
• COMMUNICATIONS: CELLULAR
• TEMPERATURE SENSOR IS NOT INCLUDED
CLIP MOUNTED TO EXISTING GRANITE CLAD STRUCTURE

FINISH SCHEDULE

PAINT COLORS - SATIN FINISH

P1: MAP METALLIC SILVER

VINYL COLORS

V1: DIGITALLY PRINTED WITH PROTECTIVE LAMINATE

APPROVED BY: _____



SIGN A.1 EXISTING CONDITIONS



SIGN A.2 EXISTING CONDITIONS



SIGN A.1 UPDATED CONDITIONS



SIGN A.2 UPDATED CONDITIONS

NOTE: BENCHES, "SANTA", AND BARRIER REMOVED FROM PHOTO TO BETTER SHOW SIGN ON STRUCTURE

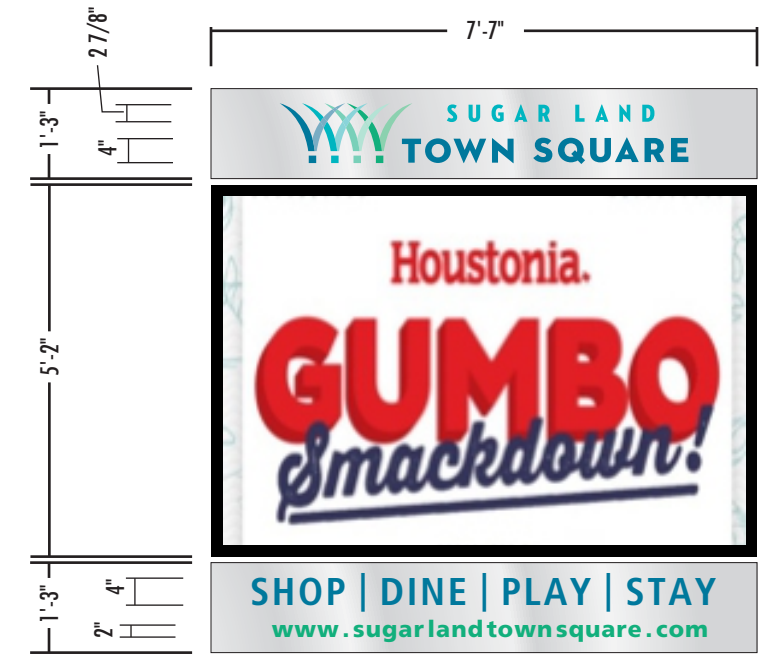

SIGN DETAILS
SCALE: 3/8" = 1'-0"

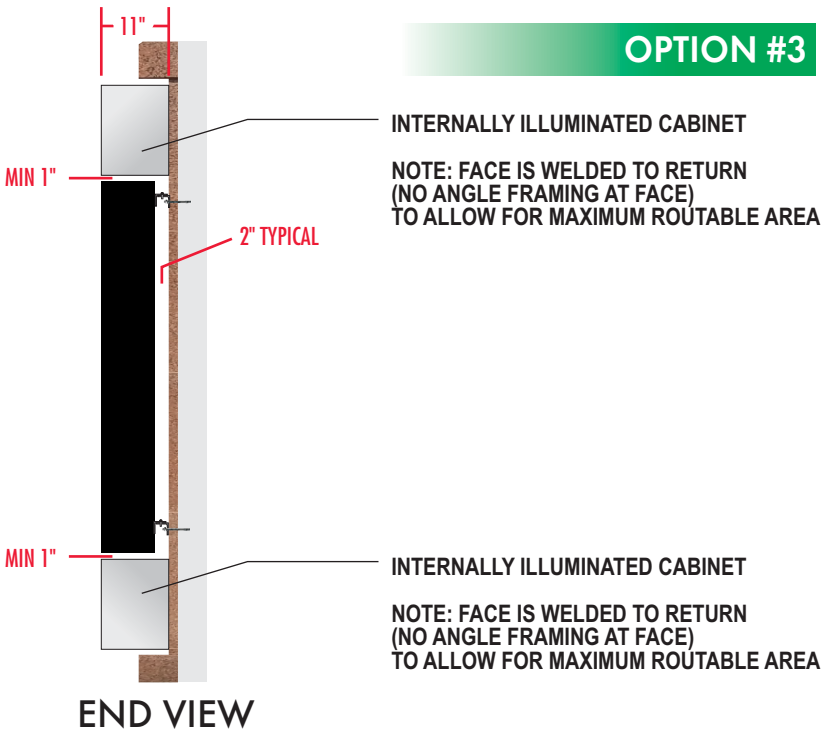

OPTION #3



National Signs

2611 EL CAMINO
HOUSTON, TEXAS 77054
TEL: 713.863.0600 • FAX: 713.863.7585
www.NationalSigns.com

PROJECT: SUGAR LAND TOWN SQUARE

LOCATION: CITY WALK BOULEVARD

CITY/STATE: SUGAR LAND, TX

SALES REP: GREGG HOLLENBERG

DATE : 2.8.2017

DRAWN BY: OUN

DRAWING#: NS17 27292



COPYRIGHT

THIS RENDERING IS THE PROPERTY OF NATIONAL SIGNS, LLC. ANY REPRODUCTION OR EXHIBITION OF THIS DRAWING IS STRICTLY PROHIBITED. ©2017 NATIONAL SIGNS, LLC. THIS RENDERING MAY NOT BE USED TO CONSTRUCT AND/OR BUILD WHAT IS DEPICTED HEREIN WITHOUT THE EXPRESS WRITTEN CONSENT OF NATIONAL SIGNS, LLC.

120 VOLT ELECTRICAL SERVICE

	SIGN	LED DISPLAY
ELECTRICAL LOAD:		
20 AMP CIRCUIT(S):		

CLIENT TO PROVIDE ALL PRIMARY ELECTRICAL SERVICES TO THE SIGN UNLESS OTHERWISE SPECIFIED

REVISIONS

A	11.15.17	ST A = NEW CONFIGS	OUN

UL INSTALLATION REQUIREMENTS
THIS SIGN IS INTENDED TO BE INSTALLED IN ACCORDANCE WITH THE REQUIREMENTS OF ARTICLE 600 OF THE NATIONAL ELECTRICAL CODE AND/OR OTHER APPLICABLE LOCAL CODES. THIS INCLUDES PROPER GROUNDING AND BONDING OF THE SIGN.

SIGN ELEVATION

SCALE: 3/16" = 1'-0"

CLIENT APPROVAL

SIGNED:

DATE:

LANDLORD APPROVAL

SIGNED:

DATE:

SALES APPROVAL



National Signs

2611 EL CAMINO
HOUSTON, TEXAS 77054
TEL: 713.863.0600 • FAX: 713.863.7585
www.NationalSigns.com

PROJECT: SUGAR LAND TOWN SQUARE

LOCATION: CITY WALK BOULEVARD

CITY/STATE: SUGAR LAND, TX

SALES REP: GREGG HOLLENBERG

DATE : 2.8.2017

DRAWN BY: OUN

DRAWING#: NS17 27292



COPYRIGHT

THIS RENDERING IS THE PROPERTY OF NATIONAL SIGNS, LLC. ANY REPRODUCTION OR EXHIBITION OF THIS DRAWING IS STRICTLY PROHIBITED. ©2017 NATIONAL SIGNS, LLC. THIS RENDERING MAY NOT BE USED TO CONSTRUCT AND/OR BUILD WHAT IS DEPICTED HEREIN WITHOUT THE EXPRESS WRITTEN CONSENT OF NATIONAL SIGNS, LLC.

120 VOLT ELECTRICAL SERVICE

	SIGN	LED DISPLAY
ELECTRICAL LOAD:		
20 AMP CIRCUIT(S):		

CLIENT TO PROVIDE ALL PRIMARY ELECTRICAL SERVICES TO THE SIGN UNLESS OTHERWISE SPECIFIED

REVISIONS

A	11.15.17	ST A = NEW CONFIGS	OUN

UL INSTALLATION REQUIREMENTS

THIS SIGN IS INTENDED TO BE INSTALLED IN ACCORDANCE WITH THE REQUIREMENTS OF ARTICLE 600 OF THE NATIONAL ELECTRICAL CODE AND/OR OTHER APPLICABLE LOCAL CODES. THIS INCLUDES PROPER GROUNDING AND BONDING OF THE SIGN.

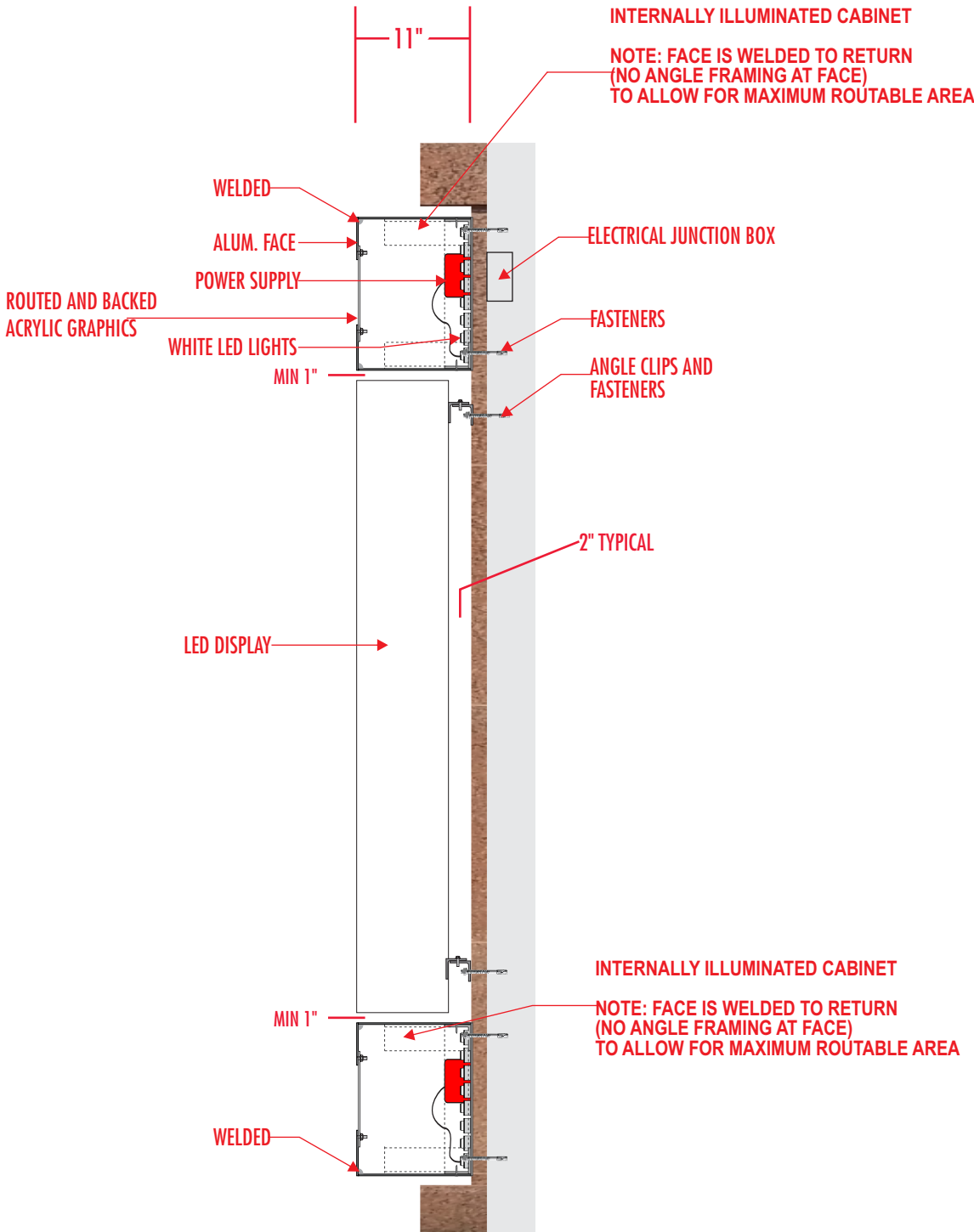

SECTION DETAILS
SCALE: 3/4" = 1'-0"

EXHIBIT B
Donation Policy

RESOLUTION NO. 04-30

**A RESOLUTION OF THE CITY COUNCIL OF THE CITY OF SUGAR LAND, TEXAS,
ADOPTING CRITERIA FOR THE DONATION OF ITEMS FOR THE SUGAR LAND TOWN
SQUARE.**

WHEREAS, Sugar Land Town Square is a 32-acre mixed use Planned Development in the City of Sugar Land; and

WHEREAS, Sugar Land Town Square includes a 1.2-Acre Public Plaza along with public rights-of-way that serve as gathering places for residents, businesses, and visitors; and

WHEREAS, the City of Sugar Land acknowledges that there is a public benefit in accepting donations for the public areas to enhance the quality and pride of Sugar Land Town Square; NOW, THEREFORE,

**BE IT RESOLVED BY THE CITY COUNCIL
OF THE CITY OF SUGAR LAND, TEXAS:**

Section 1. That the City Council adopts the following policy:

City Council Policy

Donations for Sugar Land Town Square

PURPOSE

To develop criteria for the donation of items or gifts of money designated for use in Sugar Land Town Square.

POLICY

Section 1. Definitions:

Donations or Gifts: Items or gifts of money donated to the City from a private individual, institution, organization, or other outside sources for use in Sugar Land Town Square.

FCPOA: The First Colony Property Owners' Association Inc. that reviews all architectural plans for Sugar Land Town Square.

Plaza: The 1.2 acre public plaza and fountain area located in Sugar Land Town Square adjacent to City Hall.

Relegation: The removal or relocation of donations previously accepted by the City of Sugar Land.

SLTSPOA: The Sugar Land Town Square Property Owners' Association Inc. that is responsible for collecting assessments that will be utilized in part for maintaining items in the common areas in Sugar Land Town Square, including the Plaza.

Section 2. General Criteria:

A. Donations shall:

1. Relate to the predominant theme, characteristics, or physical features of Sugar Land Town Square.
2. Have minimum maintenance requirements, and maximum resistance to vandalism, theft, weathering, and to repair cost.
3. Be considered for acceptance by the FCPOA for architectural compatibility.
4. Be considered for acceptance by the SLTSPOA for maintenance responsibility.
5. Comply with the restrictions of the Establishment Clause of the First Amendment of the United States that prohibits the City from sponsoring or promoting symbols and writings with a religious message unless the activity, project, or display: (a) has a secular purpose, and (2) its primary effect would neither advance or inhibit religion.

B. Areas for donations will include the Plaza or public rights-of-ways within the Sugar Land Town Square including accessible areas identified by the SLTSPOA.

C. Acknowledgements of the donation will be included on the donation or in close proximity of the donation; however, the acknowledgement must be minimized. The acknowledgement will be limited to the name of the donor, the date of donation, and limited spacing for the purpose of donation, (e.g., "in recognition of the 100th anniversary").

Section 3. Process:

A. Proposed donations or plans for donation shall be submitted in accordance with the submittal requirements as established by FCPOA.

B. The FCPOA shall review the item(s) utilizing the general criteria and the Sugar Land Town Square Development Guidelines.

C. The FCPOA shall submit recommended donations and gifts to the SLTSPOA for maintenance acceptance.

D. The FCPOA and the SLTS POA shall submit recommended donations and gifts to the City's City Council for acceptance.

E. Items rejected by the FCPOA and the SLTSPOA will not be submitted to the City's City Council.

F. The City will accept all donations that have been reviewed and approved by the FCPOA and SLTS POA through the City Council.

Section 4. Miscellaneous Items:

- A. Installation of donated items shall be made or supervised by the SLTSPOA and coordinated with the City of Sugar Land.
- B. All routine maintenance of donations, including cleaning, shall be the responsibility of the SLTSPOA.
- C. The SLTSPOA shall maintain an inventory of donations.
- D. The SLTSPOA will maintain an inventory of publicly accessible spaces, which are potential sites for placing donations.

Section 5. Relegation:

City Council may consider, with the recommendation of the FCPOA and the SLTSPOA, any of the following courses of action to relegate City accepted donations:

- A. Relocation of donation, or
- B. Removal of donation (removal could include return to the donor or other local government entity).

Section 6. Liability:

The City, the FCPOA, and the SLTSPOA will not be liable for loss or damage of any kind to the donation, or for any loss or damage incurred to other property or individuals as a result of the donations accepted by the City for placement in the Sugar Land Town Square. There is no obligation by either the City, FCPOA, or SLTSPOA to provide insurance for the donation. Therefore, any items damaged or destroyed may not be replaced or repaired. However, the City and SLTSPOA will exercise the same care with respect to the donation as they do in safeguarding comparable property of their own in the vicinity of the donation.

APPROVED on August 17, 2004.

David G. Wallace, Mayor

ATTEST:

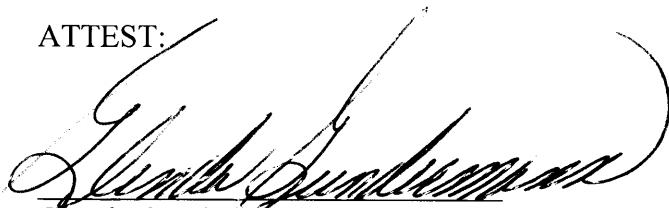
Glenda Gundermann, City Secretary

Reviewed for Legal Compliance:

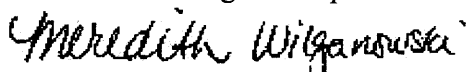

EXHIBIT C
Form of Donation of Electronic Sign Improvements

DONATION OF ELECTRONIC SIGN IMPROVEMENTS

THE STATE OF TEXAS	§	
	§	KNOW ALL MEN BY THESE PRESENTS:
COUNTY OF FORT BEND	§	

WHEREAS, LCFRE Sugar Land Town Square, LLC (LCFRE) has installed two electronic LED signs, with related wiring, electrical components and fixtures, equipment, and other appurtenances and improvements (Electronic Sign Improvements), within the right-of-way of City Walk Drive in Sugar Land Town Square, as described and shown in the attached Exhibit A, which is incorporated herein; and

WHEREAS, the Electronic Sign Improvements were installed and constructed pursuant to a Development Agreement among the Sugar Land 4B Corporation, LCFRE and the Sugar Land Town Square Property Owners' Association, Inc.(SLTSPOA); and

WHEREAS, the City and LCFRE have entered into a Donation Agreement regarding the donation of all of LCFRE's right, title, and interest in and to the Electronic Sign Improvements; and

WHEREAS, the Architectural Review Committee of First Colony Property Owners' Association, Inc. (FCPOA) has approved the Electronic Sign Improvements as being in compliance with the Sugar Land Town Square Development Guidelines and restrictive covenants applicable to Sugar Land Town Square; and

WHEREAS, the SLTSPOA has determined that City Walk Drive is part of the Common Area under the Declaration for Sugar Land Town Square recorded in File No. 2002020602, Fort Bend County, Texas Official Public Records (Town Square Declaration), for which the SLTSPOA has authority to maintain and repair the Electronic Sign Improvements as "signage, whether decorative or otherwise"; and

WHEREAS, the FCPOA and the SLTSPOA have recommended that the City accept the donation of the Electronic Sign Improvements; and

WHEREAS, the City Council approved the Criteria for Donation of Items for Sugar Land Town Square pursuant to Resolution No. 04-30 adopted on August 17, 2004 (Donation Policy); and;

WHEREAS, the donation of the Electronic Sign Improvements meets the requirements of the Donation Policy and the Donation Agreement; NOW, THEREFORE,

LCFRE donates, grants, and conveys all of its right, title and interest in and to the Electronic Sign Improvements to the City. LCFRE further assigns and transfers unto the City all of LCFRE's right, title and interest in and to (i) all tests, renderings, plans and specifications, and other plans, diagrams or studies of any kind, if any, now or hereafter in the possession of LCFRE, which relate to the Electronic Sign Improvements, (ii) any keys and codes to the Electronic Sign Improvements; and (ii) all contract and manufacturer warranties pertaining to the Electronic Sign Improvements.

LCFRE warrants that the Electronic Sign Improvements are free from any liens and encumbrances, and that LCFRE has good right, title, and authority to convey its right, title and interest in and to the Electronic Sign Improvements.

TO HAVE AND TO HOLD the above described Electronic Sign Improvements, together with all and singular the rights and appurtenances thereto in anywise belonging, unto the City, its successors and assigns forever; and LCFRE does hereby bind itself, its successors and assigns, to warrant and forever defend all and singular, the said Electronic Sign Improvements unto the City its successors and assigns, against every person whomsoever lawfully claiming or to claim the same or any part thereof.

LCRE SUGAR LAND TOWN SQUARE, LLC,
a Delaware limited liability company

By: _____

Name: _____

Title: _____

Date: _____

ATTEST:

By: _____

Name: _____

Title: _____

(SEAL)

THE STATE OF TEXAS §
§
COUNTY OF FORT BEND §

This instrument was acknowledged before me on the ____ day of _____, 2018, by
_____, _____ of LCFRE SUGAR LAND TOWN
SQUARE, LLC, a Delaware limited liability company, on behalf of said limited liability company.

Notary Public, State of Texas

My commission expires: _____

ACCEPTED by the City Manager of the City of Sugar Land, on behalf of the City of Sugar Land, pursuant to the Donation Agreement.

By: _____
Allen Bogard
City Manager, City of Sugar Land

Date: _____

THE STATE OF TEXAS §
 §
COUNTY OF FORT BEND §

This instrument was acknowledged before me on this ____ day of _____
2018, by Allen Bogard, City Manager of the City of Sugar Land.

Notary Public in and for the State of Texas
My commission expires: _____

APPROVED AS TO FORM:

AFTER RECORDING, RETURN TO:

City of Sugar Land
City Secretary's Office
P.O. Box 110
Sugar Land, Texas 77487-0110

EXHIBIT A
Electronic Sign Improvements

SIGN TYPE A

QUANTITY: 2

REMOVE AND DISPOSE OF PRINT ADS ON ONE SIDE OF TWO EXISTING FOUR SIDED STRUCTURES
REPLACE WITH NEW SIGNS AS NOTED

FABRICATE AND INSTALL SINGLE FACED LED DISPLAYS AND SINGLE FACED CABINETS
ONTO TWO EXISTING FOUR SIDED STRUCTURES
- ONE DISPLAY & TWO INTERNALLY ILLUMINATED CABINETS PER STRUCTURE

INTERNALLY ILLUMINATED CABINETS: ALL ALUMINUM FABRICATION PAINTED P1 - ALL GRAPHICS: ROUTED INTO FACE AND BACKED WITH 3/16" 7328 WHITE ACRYLIC WITH V1 VINYL APPLIED INTERNALLY ILLUMINATED WITH WHITE LEDS
FLUSH MOUNTED TO EXISTING GRANITE CLAD STRUCTURE

LED DISPLAY:

- 144 X 216 FULL COLOR LED MATRIX (10mm PIXEL PITCH)
- 5' - 2" HIGH X 7' - 7" WIDE CABINET
- 4' - 10" HIGH X 7'-2" WIDE DISPLAY AREA
- FULLY PROGRAMABLE GRAPHICS AND TEXT
- COMMUNICATIONS: CELLULAR
- TEMPERATURE SENSOR IS NOT INCLUDED
- CLIP MOUNTED TO EXISTING GRANITE CLAD STRUCTURE

FINISH SCHEDULE

PAINT COLORS - SATIN FINISH

 P1: MAP METALLIC SILVER

VINYL COLORS

 V1: DIGITALLY PRINTED WITH PROTECTIVE LAMINATE

APPROVED BY: _____



SIGN A.1 EXISTING CONDITIONS



SIGN A.2 EXISTING CONDITIONS



SIGN DETAILS
SCALE: 3/8" = 1'-0"

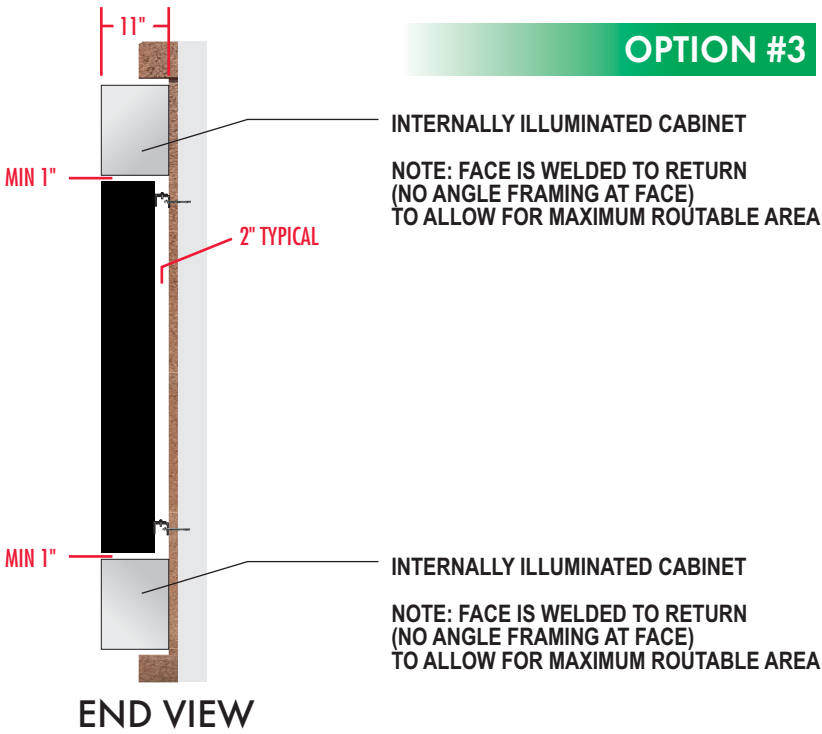

SIGN A.1 UPDATED CONDITIONS

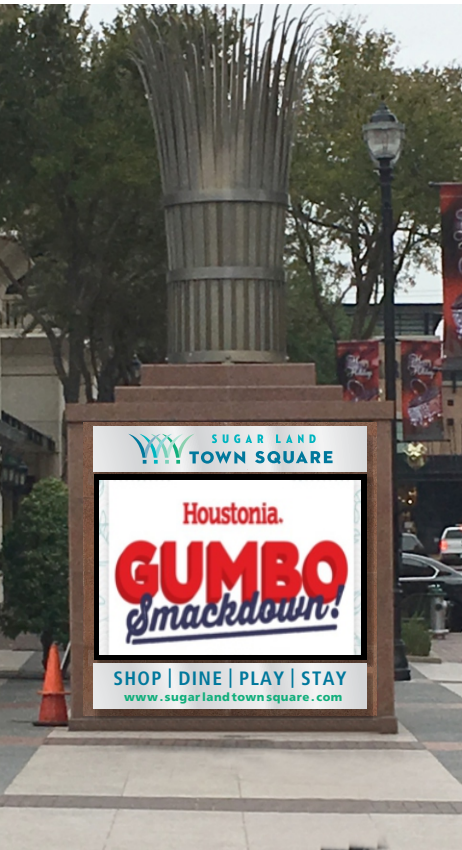

SIGN A.2 UPDATED CONDITIONS

NOTE: BENCHES, "SANTA", AND BARRIER REMOVED FROM PHOTO
TO BETTER SHOW SIGN ON STRUCTURE

SIGN ELEVATION
SCALE: 3/16" = 1'-0"



National Signs

2611 EL CAMINO
HOUSTON, TEXAS 77054
TEL: 713.863.0600 • FAX: 713.863.7585
www.NationalSigns.com

PROJECT: SUGAR LAND TOWN SQUARE

LOCATION: CITY WALK BOULEVARD

CITY/STATE: SUGAR LAND, TX

SALES REP: GREGG HOLLENBERG

DATE : 2.8.2017

DRAWN BY: OUN

DRAWING#: NS17 27292



COPYRIGHT

THIS RENDERING IS THE PROPERTY OF NATIONAL SIGNS, LLC. ANY REPRODUCTION OR EXHIBITION OF THIS DRAWING IS STRICTLY PROHIBITED. ©2017 NATIONAL SIGNS, LLC. THIS RENDERING MAY NOT BE USED TO CONSTRUCT AND/OR BUILD WHAT IS DEPICTED HEREIN WITHOUT THE EXPRESS WRITTEN CONSENT OF NATIONAL SIGNS, LLC.

120 VOLT ELECTRICAL SERVICE

	SIGN	LED DISPLAY
ELECTRICAL LOAD:		
20 AMP CIRCUIT(S):		

CLIENT TO PROVIDE ALL PRIMARY ELECTRICAL SERVICES TO THE SIGN UNLESS OTHERWISE SPECIFIED

REVISIONS

A	11.15.17	ST A = NEW CONFIGS	OUN

UL INSTALLATION REQUIREMENTS

THIS SIGN IS INTENDED TO BE INSTALLED IN ACCORDANCE WITH THE REQUIREMENTS OF ARTICLE 600 OF THE NATIONAL ELECTRICAL CODE AND/OR OTHER APPLICABLE LOCAL CODES. THIS INCLUDES PROPER GROUNDING AND BONDING OF THE SIGN.



National Signs

2611 EL CAMINO
HOUSTON, TEXAS 77054
TEL: 713.863.0600 • FAX: 713.863.7585
www.NationalSigns.com

PROJECT: SUGAR LAND TOWN SQUARE

LOCATION: CITY WALK BOULEVARD

CITY/STATE: SUGAR LAND, TX

SALES REP: GREGG HOLLENBERG

DATE : 2.8.2017

DRAWN BY: OUN

DRAWING#: NS17 27292

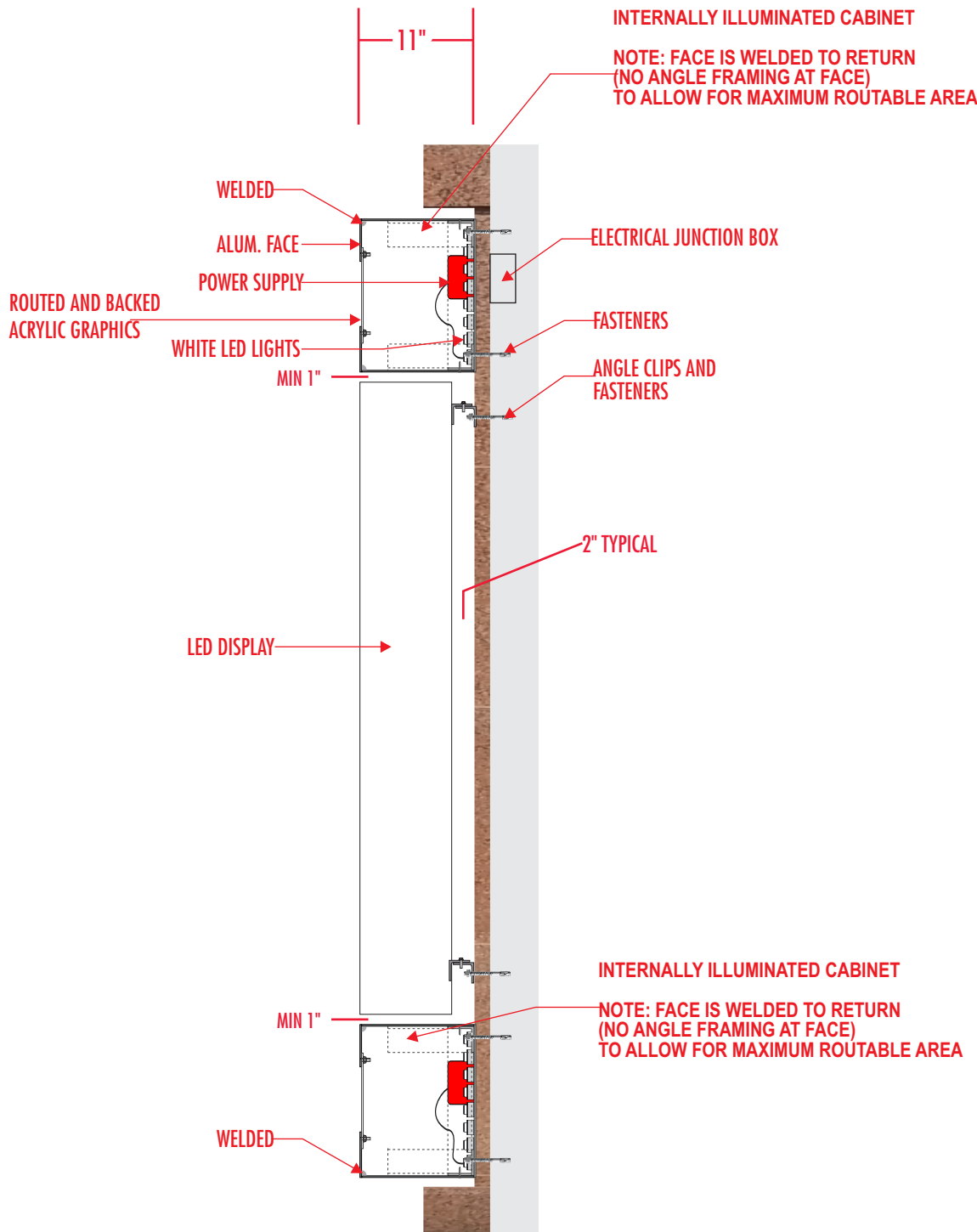

COPYRIGHT

THIS RENDERING IS THE PROPERTY OF NATIONAL SIGNS, LLC. ANY REPRODUCTION OR EXHIBITION OF THIS DRAWING IS STRICTLY PROHIBITED. ©2017 NATIONAL SIGNS, LLC. THIS RENDERING MAY NOT BE USED TO CONSTRUCT AND/OR BUILD WHAT IS DEPICTED HEREIN WITHOUT THE EXPRESS WRITTEN CONSENT OF NATIONAL SIGNS, LLC.

120 VOLT ELECTRICAL SERVICE

	SIGN	LED DISPLAY
ELECTRICAL LOAD:		
20 AMP CIRCUIT(S):		

CLIENT TO PROVIDE ALL PRIMARY ELECTRICAL SERVICES TO THE SIGN UNLESS OTHERWISE SPECIFIED

REVISIONS

	DATE	DESCRIPTION	BY
A	11.15.17	ST A = NEW CONFIGS	OUN

UL INSTALLATION REQUIREMENTS

THIS SIGN IS INTENDED TO BE INSTALLED IN ACCORDANCE WITH THE REQUIREMENTS OF ARTICLE 600 OF THE NATIONAL ELECTRICAL CODE AND/OR OTHER APPLICABLE LOCAL CODES. THIS INCLUDES PROPER GROUNDING AND BONDING OF THE SIGN.

SECTION DETAILS
SCALE: 3/4" = 1'-0"